



Aluminium Sliding Patio Doors

**UKDOORS**  
ONLINE



## Why choose aluminium?

Aluminium is extremely durable and more hard-wearing than other materials on the market. You'll be able to enjoy your aluminium doors for decades to come due to their high resistance to the elements.

It is also an incredibly strong material, providing a high level of security and impact resistance.

Aluminium doors are among the best-insulated on the market thanks to advanced thermal break technology, which prevents cold transfer.

They also require very little maintenance to ensure optimal performance and a fresh appearance.





# Slide Into *Elegance...*

**Discover uninterrupted views with Aluminium Sliding Patio Doors from UK Doors Online.**

Transform your home with our striking aluminium patio doors, elevating both aesthetics and your property's value.

The innovative design of our sliding door system boasts exceptional thermal efficiency and ultra-sleek profiles, maximising the glass area while minimising visible framework.

Experience effortless operation with our engineering-grade hardware, ensuring seamless opening and closing of the sliding doors for many years to come.

Rest assured as our doors undergo rigorous European safety testing and are powder coated to Qualicoat standards, providing ultimate peace of mind that your patio doors are built to last and designed to perform.



## ULTRA-MODERN, ULTRA-SLIM



With features designed specifically for the UK market, our patio doors also offer excellent thermal performance, with impressive U-values as low as 1.4 U/m<sup>2</sup>K. The doors are also proven to improve noise reduction and are fitted with the highest security features, exceeding PAS24:2022 standards.

The sliding patio door has been designed to accommodate multiple glazing options including double or triple-glazed units and blinds in glass. Innovative engineering allows for large expanses of glass to create a striking visual impact.

## COLOURS

Our doors are available in three standard colours, plus two dual colour options.

For projects requiring bespoke coloured doors, any RAL colour can be available upon request.

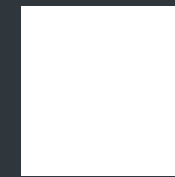

White  
RAL 9016



Grey  
RAL 7016



Black  
RAL 9005



Grey Out/  
White In



Black Out/  
White In

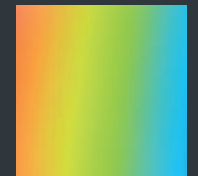

Bespoke RAL  
colour

If you're looking to enhance the aesthetic appeal and functionality of your home, aluminium sliding patio doors are the perfect solution. Whether you have a beautiful garden or a cosy balcony, these doors allow you to bring the outdoors inside with ease.

The doors are designed for large opening sizes, achieving market-leading sash sizes of up to 2.5m x 2.7m per pane. Paired with a super-slim interlock of just 25mm, the design offers impressive expanses of uninterrupted views.



# Create your perfect Patio Door



**PAS24:2022  
Compliant**

**Super-slim  
sightlines**

**Slimline  
Aluminium  
Profile**



## Maximum Weatherproofing

Designed specifically for the UK market, our patio doors have been built to withstand extreme weathering.

The doors have two levels of channelling water with rubber tubular gaskets to provide a robust seal and improved drainage. A PVC rail cover also increases thermal insulation and water protection.

## Optimum Vision

Achieving market-leading sash sizes, the doors can be made to impressive sizes of up to 2500mm x 3000mm per sash.

Paired with 25mm or 50mm interlocks, you'll get seamless views, bringing the outdoors in.

## Endless Possibilities

There is a perfect solution for every project with our sliding door system.

Choose from a wide variety of configurations, depending on the number of panes chosen and which panes you would like sliding or fixed.

## Low Maintenance

Our low-maintenance aluminium doors are strong, durable and highly corrosion-resistant. They don't need painting or staining to keep them weather-proof, and they will never rot, peel or flake.

# Glazing Options

Our Sliding Patio Doors elegantly frame and enrich outdoor areas while infusing your indoor space with natural light. Transforming entire walls into seamless expanses of glass, our doors offer unparalleled accessibility and a peaceful blend between the indoors and outdoors.

Tailor-made to your bespoke needs, our range offers double and triple-track options, enabling versatile opening configurations to suit your unique preferences. Select from our range of glazing options to complement any property style. Integral blind options are also available.

## Low E Double Glazing

Double glazing with toughened clear Low-Emissivity filled with argon gas which has a U-Value of 1.2 wkm<sup>2</sup>.

## Ultra Low E Double Glazing

An alternative to triple glazing, which can make doors heavy due to the extra weight. Ultra Low E has the same U-value as triple glazing (1.1wkm<sup>2</sup>).

## Triple Glazing

Our triple glazed units offer optimum protection and thermal efficiency benefits, achieving a U-Value of 1.1 W/m<sup>2</sup>K.

## Solar Control Glass

This type of glass uses a solar control coating, which is blue tinted, to give protection against UV rays which can cause damage over time in sunny areas to items such as furniture. It can deflect the sun rays to help overheating in sun trap areas when your doors are closed.

## Patterned Glass

We have a number of patterned glass options available. If you have one in mind please let us know, as the price and specification depend on the option.





## Integral Blinds

Integral blinds can also be incorporated between the double-glazed units, which means they won't get damaged and will never need dusting. The blinds provide can be supplied in a range of colours, as well the option of a Venetian or pleated blind.

There are three different methods of operation for the Uni-blinds, depending on your requirements and budget:

- Solar Power Uni-blinds
- Electric
- Magnetic Slider

Integral Blinds are offered with a five year manufacturing guarantee against faults. We use Morley Glass, widely recognised as the best quality blinds in glass units available.

Please note, Integral Blinds are only available for panes of glass up to 2m<sup>2</sup>, making them suited only for smaller sized sliding doors.

Manually operated blinds utilise a magnetic device to allow the blinds to be adjusted with ease however required. Available for both Venetian and pleated integral blinds.



Venetian blinds can also be motorised and come with either a wall mounted button or remote control, operating an individual blind or synchronised for up to 12 blinds at once. These can either be wired into the mains or supplied with batteries and solar panels to recharge them.



### Pleated available colours:

Pleated blinds come in a range of bold colours each with varying degrees of light reflection.

### Venetian available colours:

Venetian blinds offer increased light and solar reflection and come in a range of pastel shades and greys.





# DOOR LEAF CONFIGURATION

The Patio Door system has a variety of opening configurations, depending on how many panes are chosen and which panes you would like sliding or fixed.

There is a perfect solution for every project.



The above drawings are a selection of configuration examples. For alternative configuration options, speak to our team at [info@ukdoorsonline.co.uk](mailto:info@ukdoorsonline.co.uk) or visit [www.ukdoorsonline.co.uk](http://www.ukdoorsonline.co.uk) to design your bespoke doors online today.



Engineering  
Grade  
Hardware

PAS24:2022  
Compliant

Smooth  
Operation



# HARDWARE

## Secure Your Peace of Mind

The ultra-secure 3-star barrel provides double the sacrificial protection, made from materials 25% denser than iron and with twice the number of pins than the average lock (including an antipick pin) and 20-point drill protection as standard.

If attacked, the barrel enters 'lockdown mode', meaning the lock is practically impenetrable without heavy and noisy power tools.

The locks are also approved by the Police security initiative "Secured by Design" and are tested by the Master Locksmith Association, passing with the Sold Secure Diamond grade, known as one of the highest standards of security UK locks can conform to!



## D Handle

The D handle is a versatile handle, designed to suit a range of properties and architectural styles. Available with inline sliding operating doors, the handle is available in 6 elegant colours to suit your doors.



Polished Chrome



Black



White



Polished Gold



Smokey Chrome



Smooth Satin

## 316 Patio Door Handle

This contemporary sliding door handle is the premium choice for inline sliding doors. Available in both Black & Stainless Steel colour options.

Manufactured from 316 Marine Grade Stainless Steel, the handle is designed for ultimate durability, including where corrosion levels are high such as coastal environments.



## 316 Lift & Slide Handle

Also manufactured using 316 Marine Grade Stainless Steel, this sleek handle is designed to smoothly operate sliding doors using the lift & slide system.

Effortlessly lifting up and down to operate the doors, the handles showcase a modern look with ultimate durability. Available in both Black & Stainless Steel colour options.



# Technical Information

SUPER-SLIM INTERLOCK

At UK Doors Online, our patio doors are made to your unique requirements. From choosing the amount of panes, to colours and configurations, there are many ways you can customise your door.

Take a look at the technical information to help decide how to find your home's perfect fit.

Typical sizes (standard)	
Max door leaf width	2500mm
Max door leaf height	3000mm
Max weight (Lift & Slide)	250Kg
Max weight (Inline Slider)	210Kg

## Technical Details at a Glance:

- Market-leading maximum sash sizes of 2500mm x 3000mm.
- Maximum vision – minimal sightlines from 25mm interlock.
- Maximum security – PAS24:2022 compliant.
- Maximum insulation value – down to 1.4 U W/m<sup>2</sup>K.
- Maximum weather proofing – tested to BS6375 Part 1 : 2009.
- Single or dual colour. Factory powder coated to marine quality as per Qualicoat regulations.
- 250kg per door leaf providing for the openings.
- Double track (120mm) or triple track (183mm) options available.
- Multi-point locking as standard for the ultimate defense.



Average U-values	
CEN Standard (Double Glazed)	1.6 W/m <sup>2</sup> K
CEN Standard (Triple Glazed)	1.4 W/m <sup>2</sup> K
Glazing	
Glass Thickness	up to 32mm
Sash Profile Options	
Interlock options	25mm or 50mm
Testing	
Energy rating (WER)	C
Security	PAS24:2022 & Secured By Design
Specification	
Visible Sightline Frame/Sash	117mm
Track Options	Double / Triple
Air Permeability	600PA
Water Tightness	300PA
Wind Load Resistance	Class C2/B

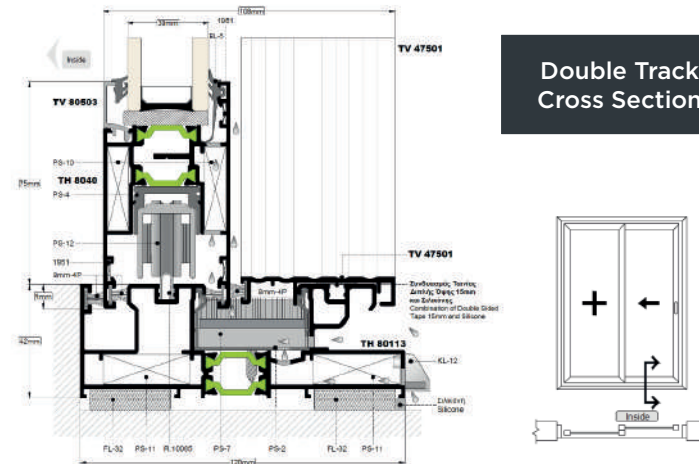

**Double Track Cross Section**

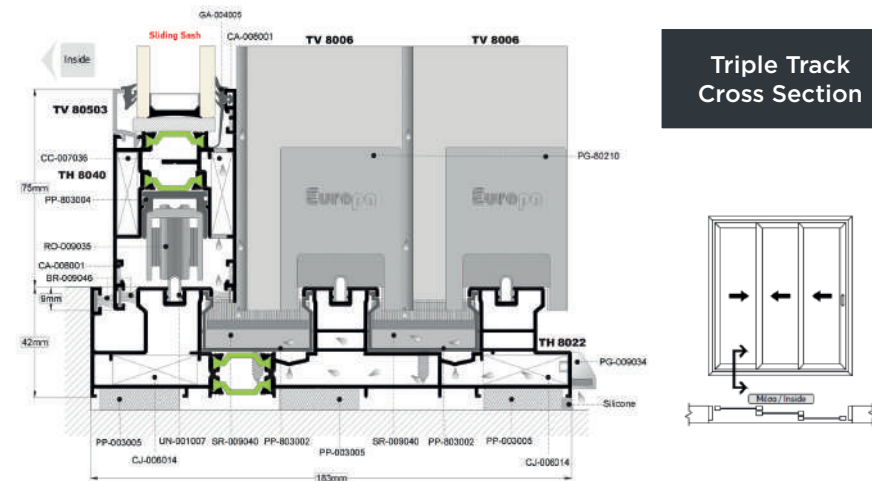

**Triple Track Cross Section**

**4 Pane Cross Section**

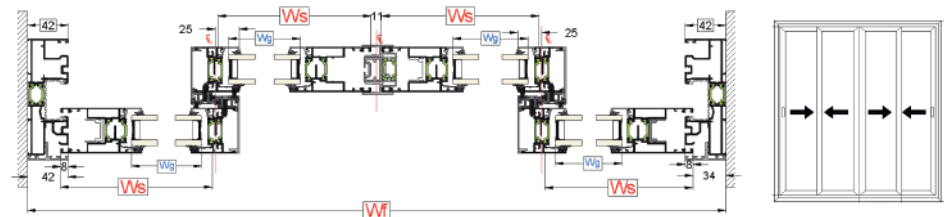

## PATIO PROFILE DETAILS

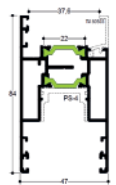

Sash Profile

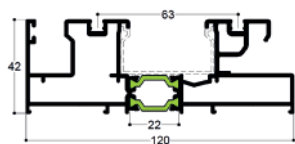

Double Track

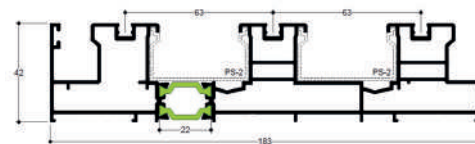

Triple Track

# Frequently asked questions...

## ***Q: Are patio doors secure?***

Yes, they are! Patio doors featuring multi-point locking mechanisms to offer enhanced security. The locks engage at multiple locking points along the door frame, providing added resistance against forced entry, alongside the strong aluminium frame and durable glass.

## ***Q: What is a Lift & Slide patio door?***

A lift and slide patio door is a type of sliding door system that features a mechanism that allows the door panels to be lifted slightly off the track before they are slid open or closed. This lifting action makes it easier to move large, heavy door panels, allowing for smooth and effortless operation.

## ***Q: How long do patio doors last?***

The lifespan of patio doors largely depends on various factors, including weather conditions and regular maintenance. With proper care, patio doors can remain functional and aesthetically pleasing for many years to come.

## ***Q: How many panes can a sliding door have?***

Our sliding patio door system can have up to six sliding panes, but must have at least three each side on a triple track. If you'd like to find out more about our full range of configuration options, get in touch with our team today.

## ***Q: What cill options can I have with a patio door?***

Either 190mm or 230mm universal cills are available for our aluminium patio door system.

## **Want to find out more?**

The opportunities are endless with our aluminium sliding doors. If you'd like to find out more or have any questions of your own, our friendly team of experts are always on hand to help.

Give us a call on 01924 929600, or email us at [info@ukdoorsonline.co.uk](mailto:info@ukdoorsonline.co.uk). Or why not head over to our website where you can ask us via our live chat? Just scan the QR code to get started!



[VISIT OUR WEBSITE >](#)



Patio Doors with Blinds in Glass





Bespoke RAL colour

# Why choose UKDOORS ? ONLINE

At UK Doors Online, we manufacture industry-leading aluminium and uPVC products specifically for the UK market.

Our excellent team have years of manufacturing expertise under their belt, ensuring our products are the best the market has to offer. Buying directly from a reliable manufacturer gives you the peace of mind to know your doors or windows are safe, secure and durable. Plus, all of our products are manufactured to the highest standards, all compliant with British Standards, Building Regulations and Security Standards, to ensure only the best systems for your home.

Multiple  
Glazing  
Options

Bespoke  
RAL colours  
on request

PAS24:2022  
Compliant

## Hear it from our customers!

**D Moore-** ★★★★★

Really great doors, fantastic value and great customer support. I would highly recommend.

**Dawn-** ★★★★★

The customer service has been second to none. Their patio doors are beautiful, strong and hardwearing. I would 100% absolutely recommend them to family, friends and anyone looking for great doors.

**T Brooks-** ★★★★★

Very impressed from start to finish! My fitter was very impressed with the quality of the system and the price. We couldn't be more pleased, great to find proper service from a UK manufacturer.

Our Roof Lantern is the perfect finishing touch to a new extension, such as a kitchen-diner, and also ideal when replacing an existing lantern roof, creating a stylish, light and airy space in the home.

Paired with our aluminium bifold doors, they create an excellent thermally efficient space, while flooding any property with natural light. The sleek minimalistic design suits all styles of homes.



Bifold Doors & Roof Lantern

# Other Products

Our product offering doesn't end with sliding patio doors. We have a full range of other aluminium & uPVC home improvement products that cater for any project, any style, and any aperture.

Other products include:

- Roof lanterns & Flat Roof Lights
- Windows & Fixed Frames
- Bifold Doors
- Composite Doors



Heritage Style Single Glazed Door & French Doors

Our Glazed Door & French Door products complement our full range of aluminium products and can be designed to coordinate with each other, or be used on their own to make a unique statement.



Composite Doors



uPVC Windows

Our range of uPVC products offer an abundance of both aesthetic and practical benefits. Designed to suit almost any property, our uPVC windows and doors are made-to-measure to suit your exacting size and style requirements.



# About Us



## Who Are We?

At UK Doors Online, we're a friendly bunch who pride ourselves on building great relationships with our customers.

Over the past few years, we've been growing our team to enhance the ways that we can best serve our customers. From stand-out service through to manufacturing and delivery, we like to keep our processes in-house to ensure the most efficient and streamlined experience for all.

Based in the heart of Yorkshire, we serve customers up and down the country on a daily basis. With no two projects the same, our friendly service team are well-versed in suggesting the best products for your application, so that you can have peace of mind in your purchase, each and every time.



## DELIVERY

Having an in-house delivery service team allows us to provide some of the fastest lead times in the industry. Our fleet of vans will travel far and wide to ensure that your products are delivered direct to your door.



## TEAM

Our excellent manufacturing process has seen us on the receiving end of multiple industry awards. We take a great deal of care in our processes in order to deliver the highest quality of bespoke products.



## SERVICE

We make it our mission to provide the highest standard of customer service with each and every customer we serve. From quote to fulfilment, our expert service team is on hand through every step of the process.

# UKDOORS ONLINE

Find us on social media!



@ukdoorsonline

UK Doors Online  
Low Mill Lane  
Ravensthorpe  
WF13 3LN

Email [sales@ukdoorsonline.co.uk](mailto:sales@ukdoorsonline.co.uk)  
Tel 01924 929 600  
[www.ukdoorsonline.co.uk](http://www.ukdoorsonline.co.uk)



Visit our website to browse our full range of products, design your doors and get a quote.